

WET63

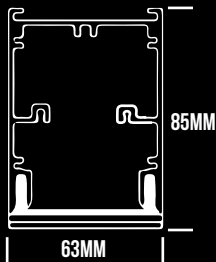
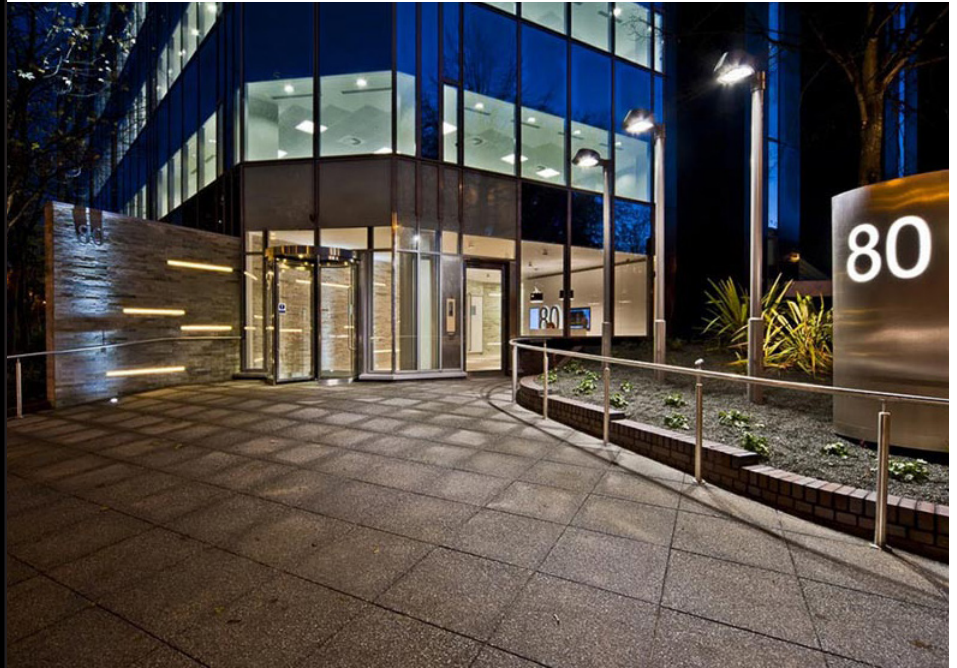

Features:

Surface mount or suspended slim profile completely sealed to IP66 for indoor and outdoor in extreme conditions.

100mm incremental length.

Provides continuous, dot-free homogeneous light output.

Superior quality components for optimum performance.

Plug and play system with factory fitted components for quick installation.

Various installation options available for surface mounting on soffit ceilings, wall mounted side hinge brackets and suspended SS wire kit.

High quality LED modules with CRI85 as standard.

Integral driver.

Extruded architectural grade T6061 aluminium, 100% recyclable.

Double LED boards for higher wattage.

Life: 50,000 hours L90/B10.

ITEM CODE	WATTAGE	COLOR TEMP	SIZE (MM)	LED LM
630237	37W	2700 K	1000X85X63	2294LM/M
630337	37W	3000 K	1000X85X63	2334LM/M
630437	37W	4000 K	1000X85X63	2379LM/M

Materials

Extruded aluminium body, aluminium sealed end caps. Opal diffuser.



Applications

Ideal to use in Airports, train stations, bus stations, malls, educational facilities, healthcare, swimming pools, pergolas and exterior applications.

Options

- **Dimming:** DALI and DSI dimming
1-10V dimming

- **CRI 95+**

- **Color Temperatures :** 2700K, 3000K, 4000K, 5000K and 6000K

- **Individual luminaire or continuous runs**

- **Customised wattages**

- **RGB LED boards**

- **Emergency modules**

- **IP54**

